

# PES



**Industrial strength in capturing:**

- **WELDING FUMES**
- **GRINDING DUSTS**
- **DRY DUSTS**
- **SOLDERING FUMES**
- **POWDERS**

**and much more...**

# PES

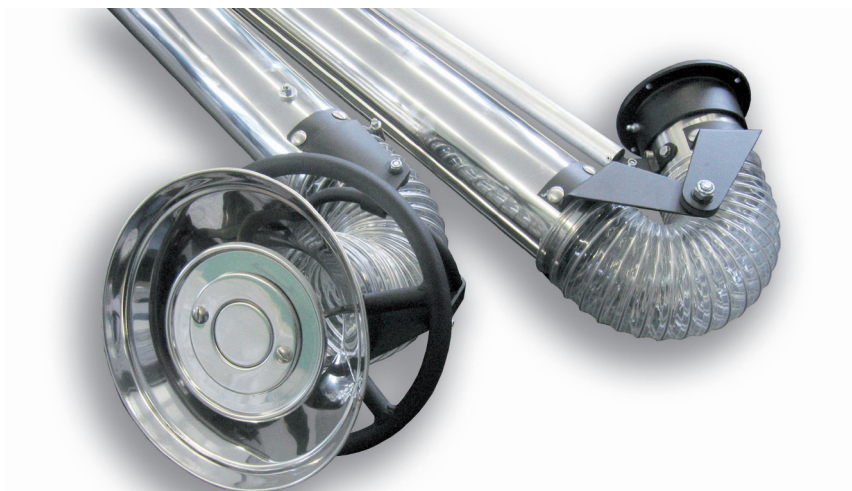

### Applications:

Welding • Grinding • Polishing • Cutting  
Soldering • Chemical Fumes and much more!

### Features:

- industrial strength
- versatile design
- smooth tube construction
- external joints and supports
- hood and tube grab handles
- air diverter in the hood
- standard damper

The fume arms are the most versatile, durable and economical method for capturing air impurities at their source. The construction of stainless steel tubes, flexible hose at joints and external cast aluminium joints allow the arm to be positioned where needed. The fume arms come in diameters of 75, 100, 125, 160 and 200mm and lengths up to 4m.

### Benefits:

- long lasting
- user-friendly operation
- higher airflow performance
- easy to adjust and maintain
- simple positioning
- increased capture velocity
- damper with-in the price

All these fume arms can be easily equipped with a light kit or larger hood diameters. The fume arms combine easily with the sliding suction rails, extension booms, fans and modular units.



All External Joints and Supports



Standard Damper



Air Diverter and Grab Handle  
all around the Hood

# PES

## Industrial Strength Construction

- 1** HOOD JOINT  
Hood easily positions forward, backward and sideways.  
All external adjustments.  
Flexible hose with gear clamps
- 2** MIDDLE JOINT  
All external adjustments.  
Flexible hose with gear clamps.
- 3** SOCKET JOINT  
Rotating swivel with safety stop.  
All external adjustments.  
Flexible hose with gear clamps.

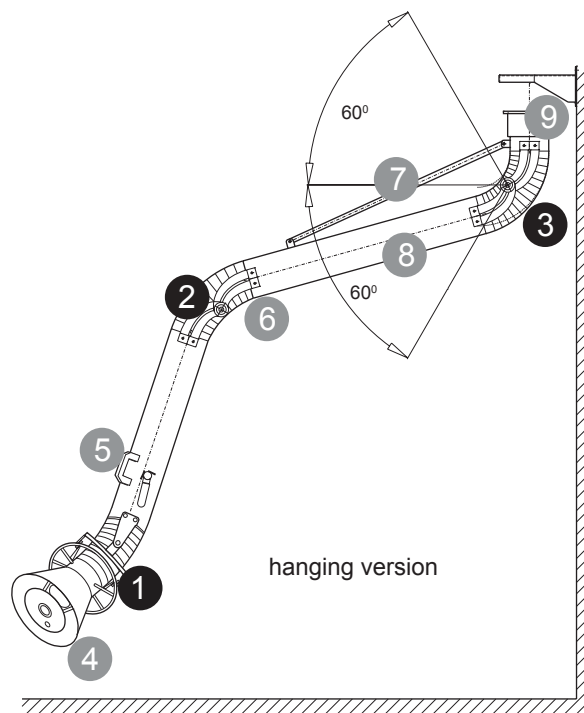
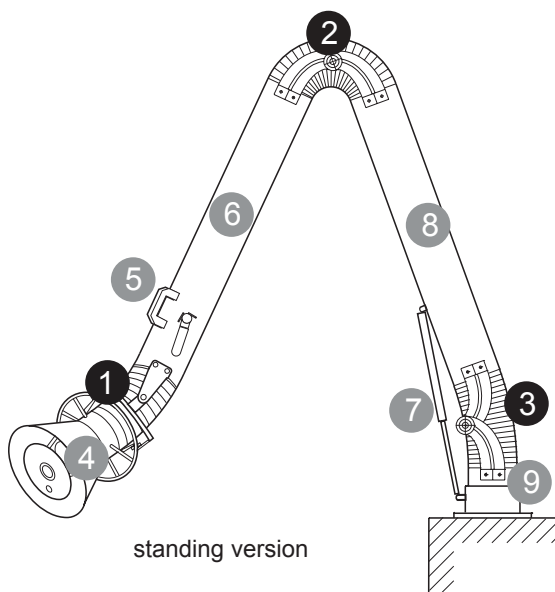

- 4** Stainless hood (powder coated) with surrounding grab handle, ready to be fitted with optional light kit.
- 5** Additional tube grab handle.
- 6** Smooth stainless steel tube with standard damper.
- 7** Support spring or gas shock on the outside on both versions.
- 8** Smooth stainless steel tube.
- 9** Swivel base with predrilled mounting holes

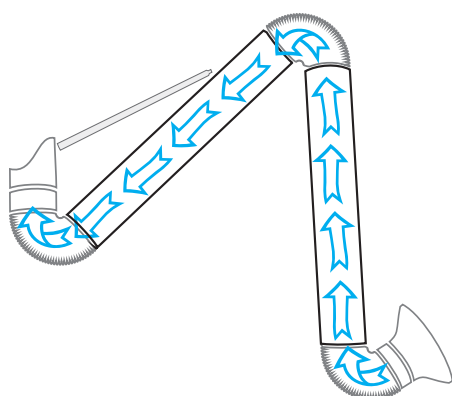

### External components

- smooth airflow
- low static pressure
- quick cleaning
- minimal build up

# PES

### Technical Data

| Model | Arm reach<br>[feet]/[m] | Arm diameter<br>[inch]/[mm] | Hood diameters<br>[inch]/[mm] |
|-------|-------------------------|-----------------------------|-------------------------------|
| 0710  | 3 / 1,0                 | 3 / 76                      | 4 / 160                       |
| 0715  | 5 / 1,5                 | 3 / 76                      | 4 / 160                       |
| 1015  | 5 / 1,5                 | 4 / 100                     | 8 / 200                       |
| 1020  | 7 / 2,0                 | 4 / 100                     | 8 / 200                       |
| 1025  | 8 / 2,5                 | 4 / 100                     | 8 / 200                       |
| 1220  | 7 / 2,0                 | 5 / 125                     | 12 / 315                      |
| 1225  | 8 / 2,5                 | 5 / 125                     | 10 / 315                      |
| 1230  | 10 / 3,0                | 5 / 125                     | 12 / 315                      |
| 1620  | 7 / 2,0                 | 6 / 160                     | 12 (14) / 315 (350)           |
| 1630  | 10 / 3,0                | 6 / 160                     | 12 (14) / 315 (350)           |
| 1640  | 14 / 4,0                | 6 / 160                     | 12 (14) / 315 (350)           |
| 2020  | 7 / 2,0                 | 8 / 200                     | 14 (20) / 350 (500)           |
| 2030  | 10 / 3,0                | 8 / 200                     | 14 (20) / 350 (500)           |
| 2040  | 14 / 4,0                | 8 / 200                     | 14 (20) / 350 (500)           |

### Static Pressure & Air Flow

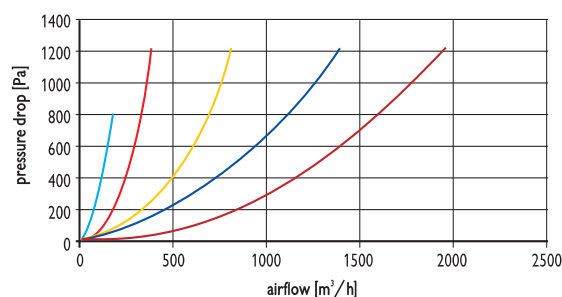
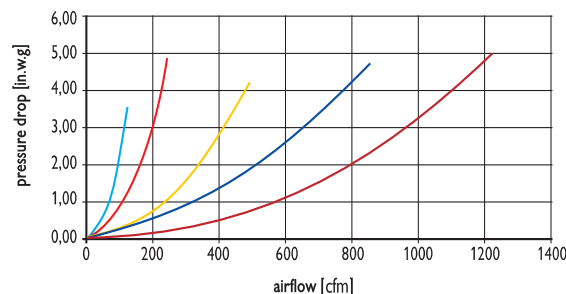

### Standard wall mounting brackets

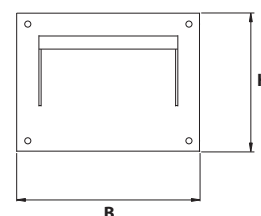
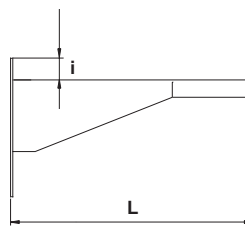
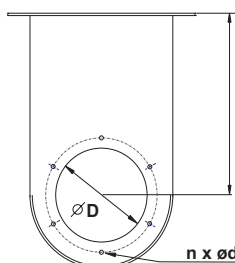
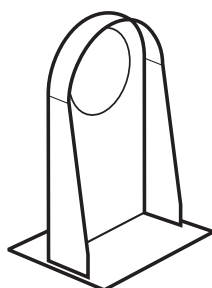

| Bracket type<br>Ø [in.]/[mm] | n | Ø D<br>[in.]/[mm] | I<br>[in.]/[mm] | L<br>[in.]/[mm] | i<br>[in.]/[mm] | B<br>[in.]/[mm] | H<br>[in.]/[mm] | weight<br>lb/[kg] | Part<br>number |
|------------------------------|---|-------------------|-----------------|-----------------|-----------------|-----------------|-----------------|-------------------|----------------|
| 3"/ 76                       | 4 | 3.15 / 80         | 3.54 / 90       | 6.69 / 170      | -               | 5.43 / 138      | 3.94 / 100      | 1 / 0.45          | P07010001      |
| 4"/ 100                      | 4 | 3.94 / 100        | 3.94 / 100      | 7.48 / 190      | -               | 6.30 / 160      | 3.94 / 100      | 1 / 0.45          | P07010002      |
| 5"/ 125                      | 6 | 4.92 / 125        | 6.02 / 153      | 9.96 / 253      | 1.38 / 35       | 9.45 / 240      | 6.30 / 160      | 8 / 3.6           | P07010003      |
| 6"/ 160                      | 6 | 6.30 / 160        | 10.00 / 254     | 14.72 / 374     | 1.38 / 35       | 9.84 / 250      | 6.50 / 165      | 8 / 3.6           | P07010004      |
| 8"/ 200                      | 8 | 8.07 / 205        | 12.36 / 314     | 18.11 / 460     | 1.57 / 40       | 12.99 / 330     | 9.84 / 250      | 14 / 6.3          | P07010005      |